

# ロードウォール H=1750 配筋図

配筋					
記号	径 (mm)	長さ (mm)	本数 (本)	質量 (kg)	形状 材質
①	D13	1950	4	7.77	┌ SD295
①'	D10	1890	4	4.24	┌ //
②	D13	1350	4	5.38	┌ //
②'	D10	1290	4	2.89	┌ //
③	φ6	520	7	0.808	┌ SWM-B
④	φ6	375	14	1.17	┌ //
⑤	φ6	530	4	0.471	┌ //
⑥	φ6	385	8	0.684	┌ //
⑦	D6	2780	10	6.93	┌ SD295
⑧	D6	1950	12	5.83	┌ //
TOTAL				36.2	kg

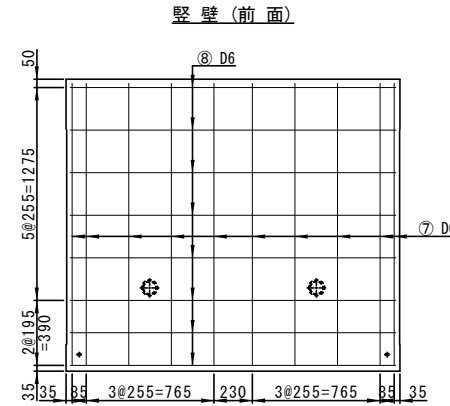
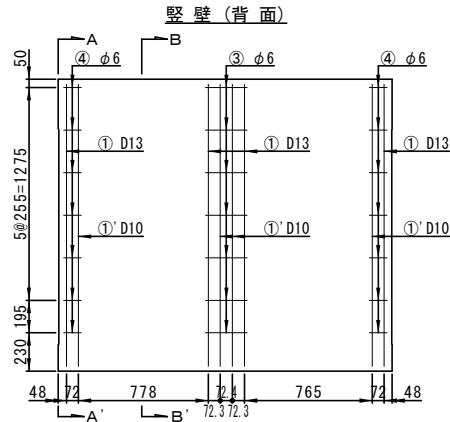
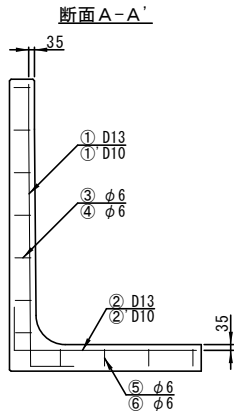

## 鉄筋加工図

① D13-1950

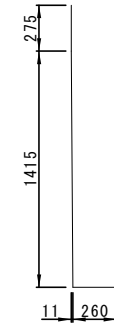

①' D10-1890

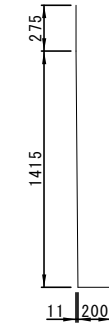

③ φ6-520

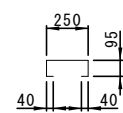

④ φ6-375

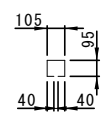

※40mmは最低寸法

⑤ φ6-530

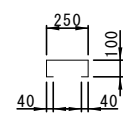

⑥ φ6-385

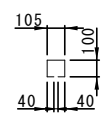

※40mmは最低寸法

② D13-1350

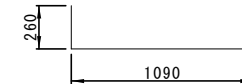

②' D10-1290

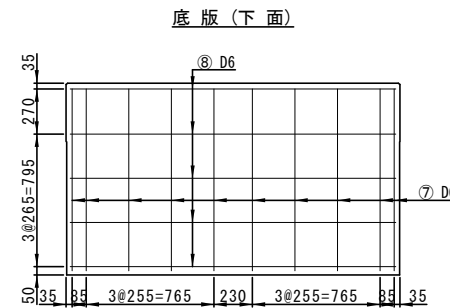
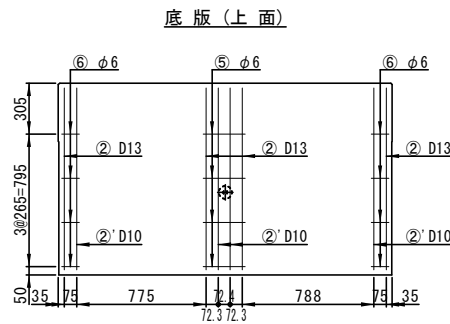
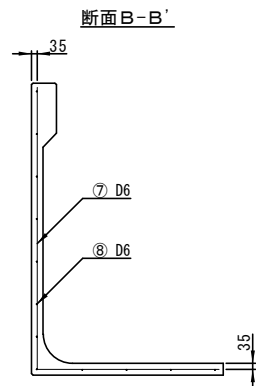
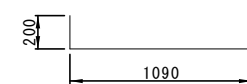

⑦ D6-2780

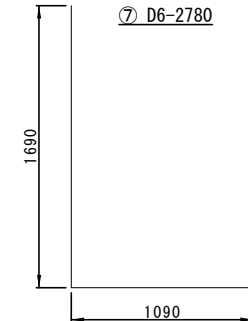

⑧ D6-1950

